

VC204 - WOOD

This beautiful side cabinet offers plenty of open shelf space at the top and three full extension drawers on the bottom. This cabinet comes standard with two adjustable wooden shelves.

The door/drawer design, crown molding style and handle choice on your cabinets will match the style of the murphy bed that you choose, unless otherwise specified.

Available in 18", 24" and 30" widths.

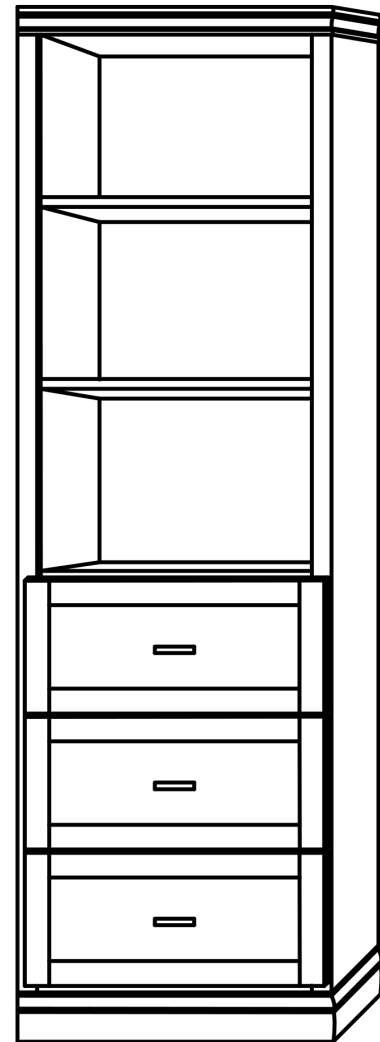

FINISHES AVAILABLE IN OAK

(Refer to Finishes Page for Names)



FINISHES AVAILABLE IN MAPLE

(Refer to Finishes Page for Names)

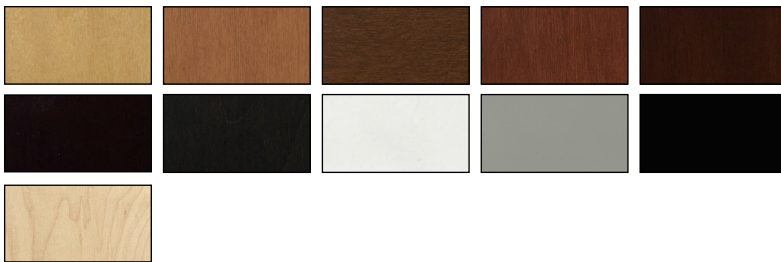

SIDE CABINET DIMENSIONS

SIZE	HEIGHT	WIDTH	DEPTH
Queen	84 1/4"	18, 24, 30"	16"
Full (Double)	79 1/4"	18, 24, 30"	16"
XL Twin	84 1/4"	18, 24, 30"	16"
Twin	79 1/4"	18, 24, 30"	16"

ADDITIONAL OPTIONS

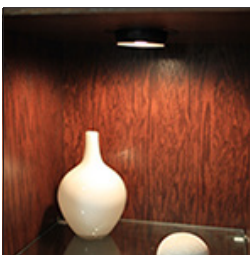

Lighting

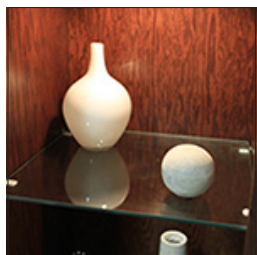

Glass Shelves



Nightstand Pull Out



The HEIGHT of our Vertical Side Cabinets sit below the height of our Vertical Murphy Beds, so they will vary based on the height of the murphy bed that is ordered. 30" wide cabinets will have double doors. Door and Drawer fronts will match the murphy bed style that is ordered. For example, cabinets that accompany the Metropolitan Face murphy bed will have flat panel doors and drawers.